

VERTICAL LIFTING CLAMP

OPERATOR'S MANUAL

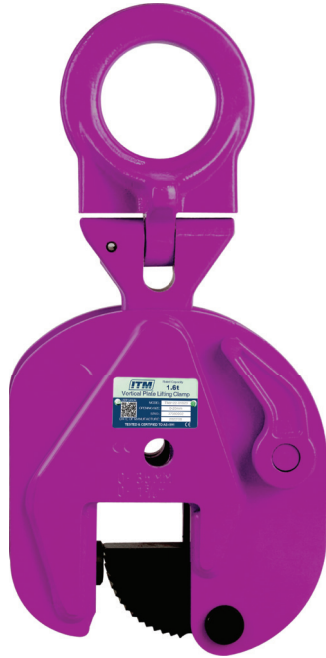

Part No:
TM9122-00815 800KG
TM9122-01620 1.6T
TM9122-02025 2.0T
TM9122-03230 3.2T
TM9122-05050 5.0T

Ver: 1.0
Serial: _____
Buyer to record serial number above



This lifting clamp should not be installed, operated or maintained by any person who has not read all the contents of these general instructions. Failure to read and comply with these instructions or any of the limitations noted herein can result in bodily injury and/or property damage.



TESTED & CERTIFIED TO AS 4991

LIMITED WARRANTY

Industrial Tool & Machinery Sales (hereinafter referred to as ITMS) will, within twelve (12) months from the original date of purchase, repair or replace any goods found to be defective in materials or workmanship. This warranty is void if the item has been damaged by accident, neglect, improper service or other causes not arising out of defects in materials or workmanship. This warranty does not apply to machines and/or components which have been altered, changed, or modified in any way, or subjected to overloading or use beyond recommended capacities and specifications. Worn componentry due to normal wear and tear is not a warranty claim. Goods returned defective shall be returned prepaid freight to ITMS or agreed repair agent, which shall be the buyer's sole and exclusive remedy for defective goods. ITMS accepts no additional liability pursuant to this guarantee for the costs of travelling or transportation of the product or parts to and from ITMS or the service agent or dealer, such costs are not included in this warranty.

Our goods come with guarantees which cannot be excluded under the Australian Consumer Law. You are entitled to replacement or refund for a major failure and to compensation for other reasonably foreseeable loss or damage. You are also entitled to have the goods repaired or replaced if the goods fail to be of acceptable quality and the failure does not amount to a major failure.

THE MANUFACTURER RESERVES THE RIGHT TO MAKE IMPROVEMENTS AND MODIFICATIONS TO DESIGN WITHOUT PRIOR NOTICE.

PRODUCTS IMPORTED AND DISTRIBUTED NATIONALLY BY:



INDUSTRIAL TOOL & MACHINERY SALES
11 EASTERN SERVICE ROAD, STAPYLTON, QLD, 4207
T: 07 3287 1114 E: sales@industrialtool.com.au
F: 07 3287 1115 W: www.itmtools.com.au

THIS PRODUCT MUST ONLY BE USED BY SUITABLY TRAINED PERSONS.

WARNING

Incorrect use can lead to major accidents involving serious to fatal bodily injuries or major damage to property.

PRECAUTIONS WHEN USING LIFTING CLAMPS

- Never use a steel lifting clamp on material other than mild steel plate!
- Never lift hardened material!
- Never vertically lift material that tapers down to the edge!
- Never vertically lift with horizontal or lateral lifting clamps!
- Never vertically lift more than one steel plate at a time!
- Always remove rust, paint, oil and other foreign matter from the surface of the steel plate before clamping!
- Never exceed the rated capacity of the lifting clamp!
- Always be sure that clamping and sling connecting operations are carried out only by personnel with the necessary qualifications!
- Always use the correct type of lifting clamp for each specific work application!
- Always be sure that the work piece is within the specified clamping range of the lifting clamp!
- Never apply a shock to the load!
- Always be sure to move the load slowly and carefully! Never abruptly stop a moving load!
- Always before use, inspect the teeth of the cam and pad to check to see that they are not clogged, worn or damaged and confirm that each section of the clamp is functioning properly!
- Never modify a lifting clamp! Heat and modifications will have negative effects on the quality (strength).
- Never stand under load!



INSPECTIONS & LOGS

Daily Inspection must be carried out each day before use, and an entry reporting on the inspection must be completed in the Inspection and Service Log at the back of this user manual. Please take a copy of the blank log before first entry so you can continue the process. Logs must be archived, and will be requested if any warranty claims or injury occurs.

WORKING RANGE

Part No.	W.L.L.	MILD STEEL PLATE THICKNESS
TM9122-00815	800KG	Maximum 15mm
TM9122-01620	1.6T	Maximum 20mm
TM9122-02025	2.0T	Maximum 25mm
TM9122-03230	3.2T	Maximum 30mm
TM9122-05050	5.0T	Maximum 50mm

PARTS LIST

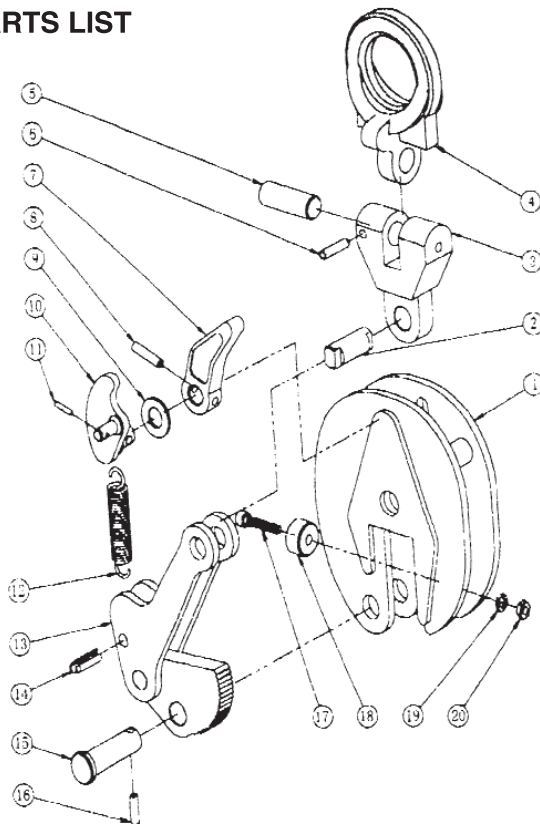

Part No.	Description
1	Body
2	Pin
3	Body Shackle
4	Top Shackle
5	Pin
6	Pin
7	Lever
8	Pin
9	Washer
10	Plate
11	Pin
12	Spring
13	Cam Assembly
14	Pin
15	Pin
16	Pin
17	Bolt
18	Jaw
19	Washer
20	Nut



Inspection & Service Log

Date	Notes	Auth Signature