

360A Air-Cooled MIG Welding Torch

Rating: 300A CO2 270A mixed gas, EN60974-7 @ 60% duty cycle. 0.8 to 1.2mm wires

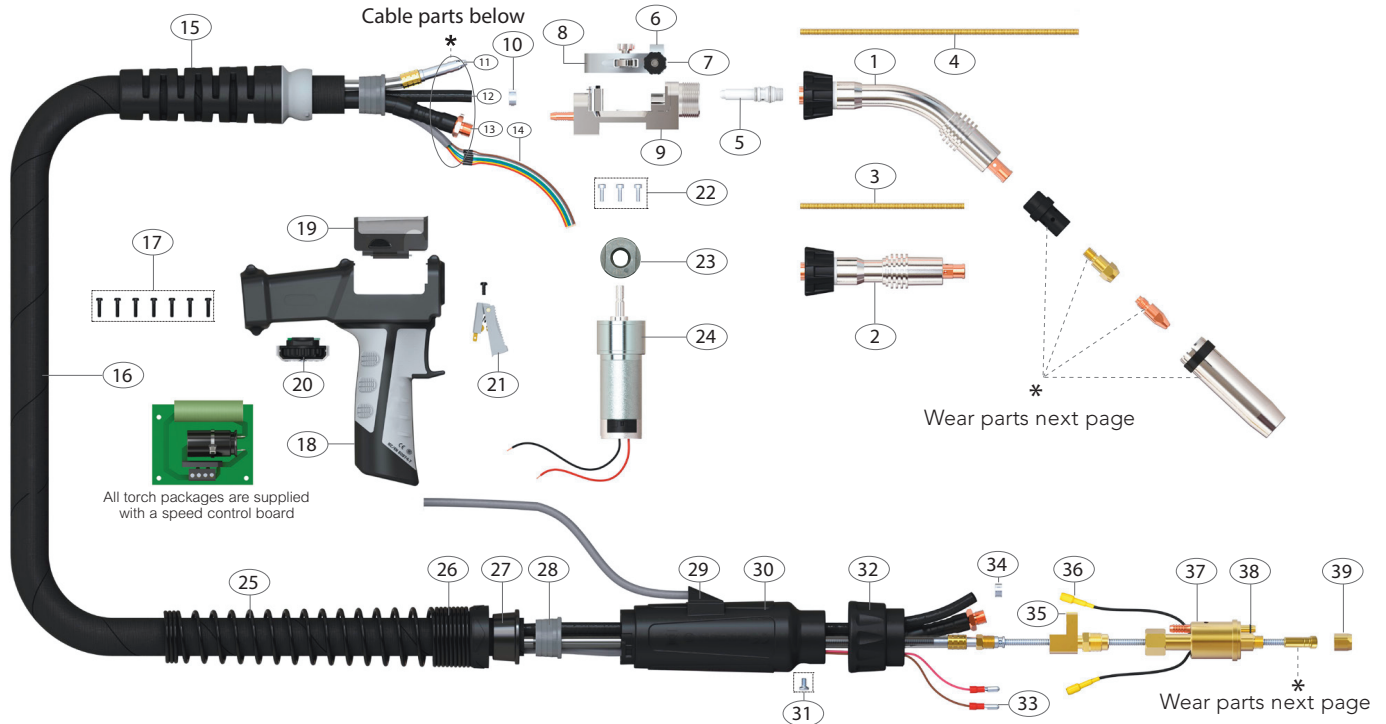

Torch Model	Description	Part Number
360 PUSH PULL MIG TORCH		8Mt
		PPLU36-24V-8M
		PPLU36-42V-8M

Spare Parts			
Part Number	Description	Part Number	Description
1	UGP3603 Swan Neck Assembly 45	24	UGP8224-24 Motor 24V DC
2	UGP3603A Straight Neck Assembly	25	UC8027 Housing Spring
3	UGP3602 Jump Liner	26	UT8028 Spring Cable Support Nut
4	UGP3602A Jump Liner	27	UT8009 Canvas Cover Clamp
5	UGP36006 Jump Liner Nipple	28	UT8010 Canvas Cover Retainer
6	UGP36402 Pressure Arm Assembly	29	USLH26-C Housing Insert
7	UGP36402B Tension Knob	30	UT5022 Gun Plug Housing Assembly
8	UGP36402R Pressure Roll	31	UB1526 Gun Plug Screw
9	UGP36001 Motor Body	32	UB1519/S Gun Plug Nut
10	UB5041 Water Hose Clamp 8.7MM	33	UB1522 Cable Terminal Male
15	UG3208 Handle Cable Support	34	UB5024 Water Hose Clamp 9.5MM
16	UGP36419-80 Canvas Cover Assembly	35	UGP3608C Power Fitting
17	UCSP1 Handle Screw	36	UB1523 Gun Plug Terminal Female
18	UGP2514/KJ Push Pull Handle	37	UGP1528 A/C Gun Plug Body Assembly
19	UGP2514/C Push Pull Handle Cover	38	UB1524 Gun Plug 'O' Ring
20	UGP0807-1 Potentiometer Kit 1K	39	UB1525 Liner Nut
	UGP0807-5 Potentiometer Kit 5K		
	UGP0807-10 Potentiometer Kit 10K		
	UGP0807-25 Potentiometer Kit 25K		
21	UGP2516 Trigger		
22	UGPMS1 Motor Screw		
23	UGP8224W-08 Drive Roll For Wire 0.8		
	UGP8224W-09 Drive Roll For Wire 0.9		
	UGP8224W-10 Drive Roll For Wire 1.0		
	UGP8224W-12 Drive Roll For Wire 1.2		
	UGP8224W-16 Drive Roll For Wire 1.6		



Cable Parts		
Description	Part Number	8M
11	Outer Liner Assembly	UGP36408-80
12	Gas Hose Assembly	UGP36413-80
13	Power Cable Assembly	UGP36015-80
14	Switch Lead Assembly	UGP36410-80

**Front end consumables**

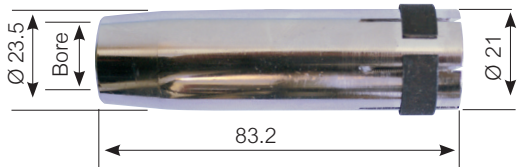
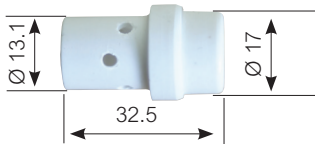
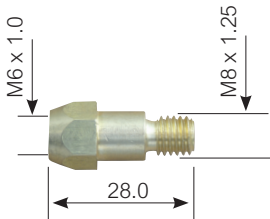
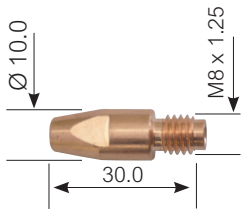
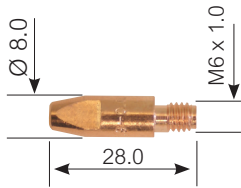

**Liners**

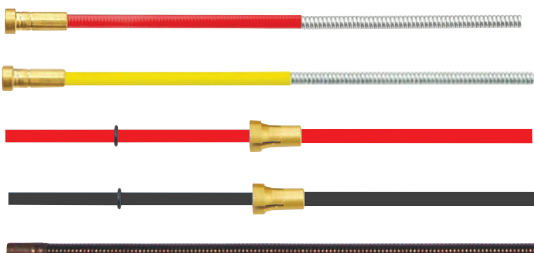

**SGPPL36 Contact Tips**

Part Number	Description	QTY10
PCT0009-06	Contact Tip Steel (0.6mm)	QTY10
PCT0009-08	Contact Tip Steel (0.8mm)	QTY10
PCT0009-09	Contact Tip Steel (0.9mm)	QTY10
PCT0009-10	Contact Tip Steel (1.0mm)	QTY10
PCT0009-12	Contact Tip Steel (1.2mm)	QTY10
PCT0009-16	Contact Tip Steel (1.6mm)	QTY10
PCTAL0009-09	Contact Tip Aluminium (0.9mm)	QTY10
PCTAL0009-10	Contact Tip Aluminium (1.0mm)	QTY10
PCTAL0009-12	Contact Tip Aluminium (1.2mm)	QTY10
PCT0005-08	Contact Tip Steel M8 (0.8mm)	QTY10
PCT0005-09	Contact Tip Steel M8 (0.9mm)	QTY10
PCT0005-10	Contact Tip Steel M8 (1.0mm)	QTY10
PCT0005-12	Contact Tip Steel M8 (1.2mm)	QTY10
PCT0005-16	Contact Tip Steel M8 (1.6mm)	QTY10
PCTAL0005-08	Contact Tip Aluminium M8 (0.8mm)	QTY10
PCTAL0005-09	Contact Tip Aluminium M8 (0.9mm)	QTY10
PCTAL0005-10	Contact Tip Aluminium M8 (1.0mm)	QTY10
PCTAL0005-12	Contact Tip Aluminium M8 (1.2mm)	QTY10
PCTAL0005-16	Contact Tip Aluminium M8 (1.6mm)	QTY10

**SGPPL36 Tip Holder M6**

Part Number	Description	QTY2
PCTH36M6S	Contact Tip Holder M6 (Short)	QTY2
PCTH36M6L	Contact Tip Holder M6 (Long)	QTY2

**SGPPL36 Tip Holder M8**

Part Number	Description	QTY2
PCTH36M8S	Contact Tip Holder M8 (Short)	QTY2
PCTH36M6L	Contact Tip Holder M6 (Long)	QTY2

**SGPPL36 Gas Diffuser**

Part Number	Description	QTY2
PCGD36	Gas Diffuser	QTY2

**SGPPL36 Gas Nozzle**

Part Number	Description	QTY2
PGN36CYL	Cylindrical Nozzle	QTY2
PGN36CON	Conical Nozzle	QTY2
PGN36TAP	Tapered Nozzle	QTY2

**SGPPL36 Liners**

Part Number	Description	
PB2524-80B	Red Steel Liner 8 Metre	0.9 - 1.2mm
PB2513-80	Red Plastic Liner 8 Metre	1.0 - 1.2mm
PB3626-80	Yellow Plastic Liner 8 Metre	1.2 - 1.6mm
NKSTL	Neck Spring for Aluminium	

These parts are manufactured in China and are offered as replacement parts suitable for "BINZEL®" style torches.