

DM36 BINZEL Style Digital MIG Torch

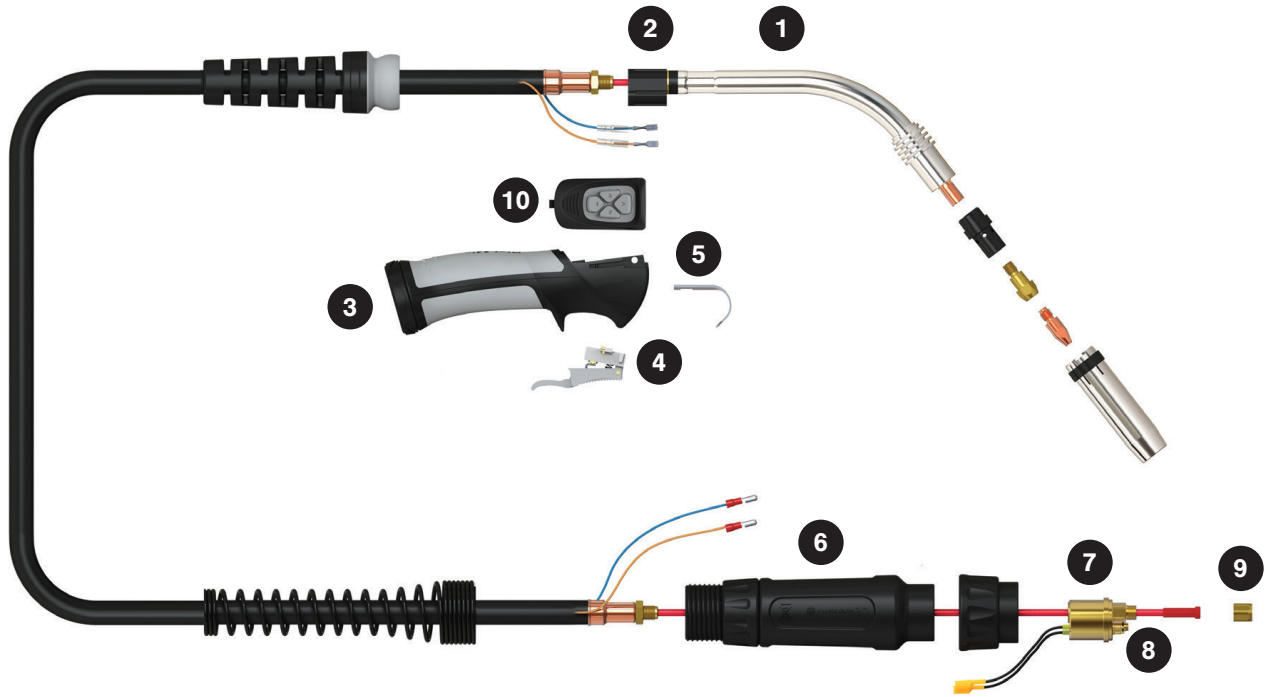

Length	3m	4m	5m
SKU	SB36 Digital Suregrip Ergo Torch PULSE	DM3600-NMM2-MT2-30ER	DM3600-NMM2-MT2-40ER

TORCH SPARES	
1	SNK36 Swan Neck Assembly
2	UG1515 Ergo Handle Location Body
3	DM2514/KJ Digi-Mig Handle Kit
4	DM2516L Extended Trigger Assembly
5	UB2517 Hanger Hook
6	UB1518L Gun Plug Housing C/W Nut
7	UB1528 Gun Plug Body C/W Spring Pins
8	UB1524 Gun Plug 'O' Ring
9	UB1525 Liner Nut
10	MM2 Logic Control Kit for Pulse Machine

TECHNICAL DATA	
COOLING METHOD	Air Cooled
DUTY CYCLE - CO2	60% @ 320A
DUTY CYCLE - MIXED GAS	60% @ 290A
WIRE SIZE	0.8-1.2mm
LENGTHS (m)	3/4/5
STANDARD	EN60974-7

DM36 Digital MIG Torch Consumables



SKU	Description	QTY
PCTH36M6L	TIP HOLDER - Long - M6	2
PCTH36M6S	TIP HOLDER - Short - M6	2
PCTH36M8L	TIP HOLDER - Long - M8	2
PCTH36M8S	TIP HOLDER - Short - M8	2



SKU	Description	QTY
PCGD36	GAS DIFFUSER	2



SKU	Description	QTY
PCT0005-08	CONTACT TIPS - Steel 0.8mm - M8	10
PCT0005-09	CONTACT TIPS - Steel 0.9mm - M8	10
PCT0005-10	CONTACT TIPS - Steel 1.0mm - M8	10
PCT0005-12	CONTACT TIPS - Steel 1.2mm - M8	10
PCT0005-16	CONTACT TIPS - Steel 1.6mm - M8	10
PCT0009-06	CONTACT TIPS - Steel 0.6mm - M6	10
PCT0009-08	CONTACT TIPS - Steel 0.8mm - M6	10
PCT0009-09	CONTACT TIPS - Steel 0.9mm - M6	10
PCT0009-10	CONTACT TIPS - Steel 1.0mm - M6	10
PCT0009-12	CONTACT TIPS - Steel 1.2mm - M6	10
PCT0009-16	CONTACT TIPS - Steel 1.6mm - M6	10
PCTAL0005-08	CONTACT TIPS - Aluminium 0.8mm - M8	10
PCTAL0005-09	CONTACT TIPS - Aluminium 0.9mm - M8	10
PCTAL0005-10	CONTACT TIPS - Aluminium 1.0mm - M8	10
PCTAL0005-12	CONTACT TIPS - Aluminium 1.2mm - M8	10
PCTAL0005-16	CONTACT TIPS - Aluminium 1.6mm - M8	10
PCTAL0009-09	CONTACT TIPS - Aluminium 0.9mm - M6	10
PCTAL0009-10	CONTACT TIPS - Aluminium 1.0mm - M6	10
PCTAL0009-12	CONTACT TIPS - Aluminium 1.2mm - M6	10



SKU	Description	QTY
PGN36CON	GAS NOZZLE - Conical	2
PGN36CYL	GAS NOZZLE - Cylindrical	2
PGN36TAP	GAS NOZZLE - Tapered	2



SKU	Description	Wire Size
SLB3M	Blue Steel Liner 3 Metre	0.6 - 0.8mm
SLB4M	Blue Steel Liner 4 Metre	0.6 - 0.8mm
SLB5M	Blue Steel Liner 5 Metre	0.6 - 0.8mm
SLR3M	Red Steel Liner 3 Metre	0.9 - 1.2mm
SLR4M	Red Steel Liner 4 Metre	0.9 - 1.2mm
SLR5M	Red Steel Liner 5 Metre	0.9 - 1.2mm
SLY3M	Yellow Steel Liner 3 Metre	1.2 - 1.6mm
SLY4M	Yellow Steel Liner 4 Metre	1.2 - 1.6mm
SLY5M	Yellow Steel Liner 5 Metre	1.2 - 1.6mm
TLB3M	Blue Aluminium Liner 3 Metre	0.6 - 0.8mm
TLB4M	Blue Aluminium Liner 4 Metre	0.6 - 0.8mm
TLR3M	Red Aluminium Liner 3 Metre	0.9 - 1.2mm
TLR4M	Red Aluminium Liner 4 Metre	0.9 - 1.2mm
TLY3M	Yellow Aluminium Liner 3 Metre	1.2 - 1.6mm
TLY4M	Yellow Aluminium Liner 4 Metre	1.2 - 1.6mm
NKSTL	Neck Spring for Aluminium	